



### Input

|                     |                                                  |
|---------------------|--------------------------------------------------|
| Rated input voltage | 100 V- 240 V ac                                  |
| Input voltage range | 90 V to 264 V ac                                 |
| Rated frequency     | 50-60 Hz                                         |
| Frequency range     | 47-63 Hz                                         |
| Rated input current | 600 mA RMS max.                                  |
| Inrush current      | 40A max at 115 / 80 A max. at 230 Vac cool start |
| Leakage current     | 0.25 mA                                          |

### Output

|                          |                                               |
|--------------------------|-----------------------------------------------|
| Output voltage           | 6 Vdc at 3.0 A                                |
| Output min. current      | 0A                                            |
| Line regulation          | ± 1%                                          |
| Load regulation          | ± 5%                                          |
| Over voltage protection  | 7.1 to 7.9 Vdc (output shut down)             |
| Short circuit protection | output shut down and auto restart             |
| Ripple voltage           | 150 mV (p-p) (100-240 Vac input at full load) |
| Efficiency               | Energy Star compliant - level IV              |

### Safety and EMI

|                       |                                 |                                            |
|-----------------------|---------------------------------|--------------------------------------------|
| HI-POT                | input to output                 | 3000 Vac or 4242 Vdc at 10 mA for 1 minute |
| Insulation resistance | input to output                 | > 100 M Ohm at 500 Vdc                     |
| Safety approvals      | UL/cUL, CE, GS                  |                                            |
| EMI standard          | FCC, meets class B, CE, VCCI-II |                                            |
| RoHS compliant        | yes                             |                                            |

### Environmental

|                             |                |
|-----------------------------|----------------|
| Storage temperature         | -10°C ~ +70° C |
| Storage humidity            | 10~90%         |
| Operating temperature       | 0°C ~ +40° C   |
| Operating relative humidity | 20~80%         |

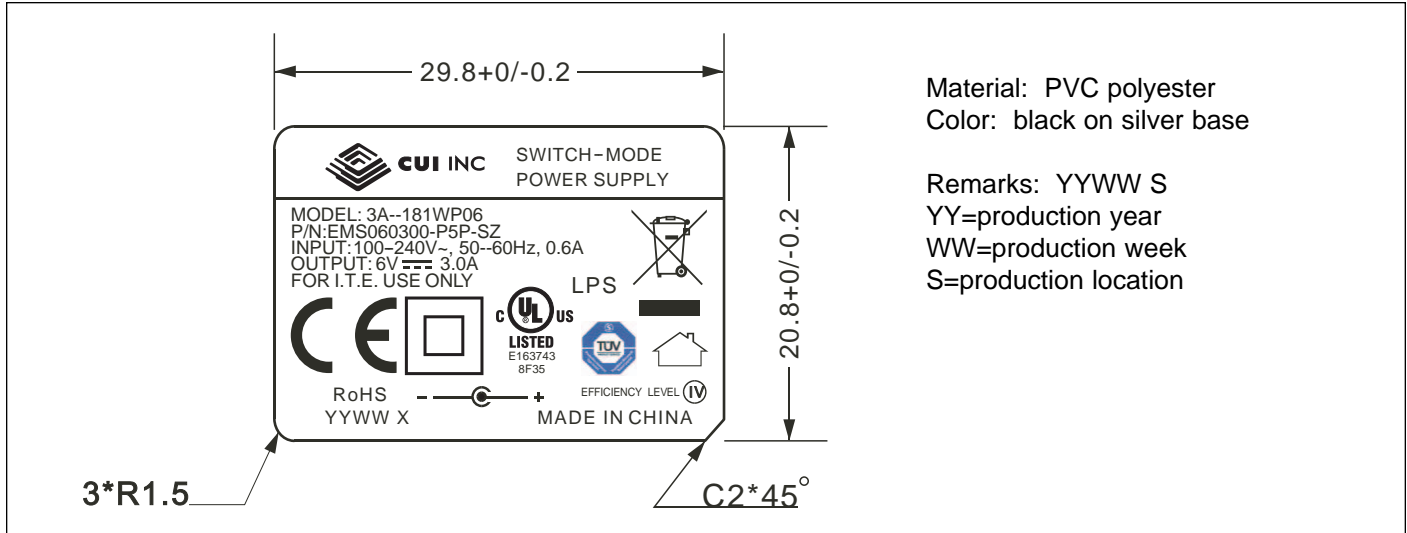
**Label**

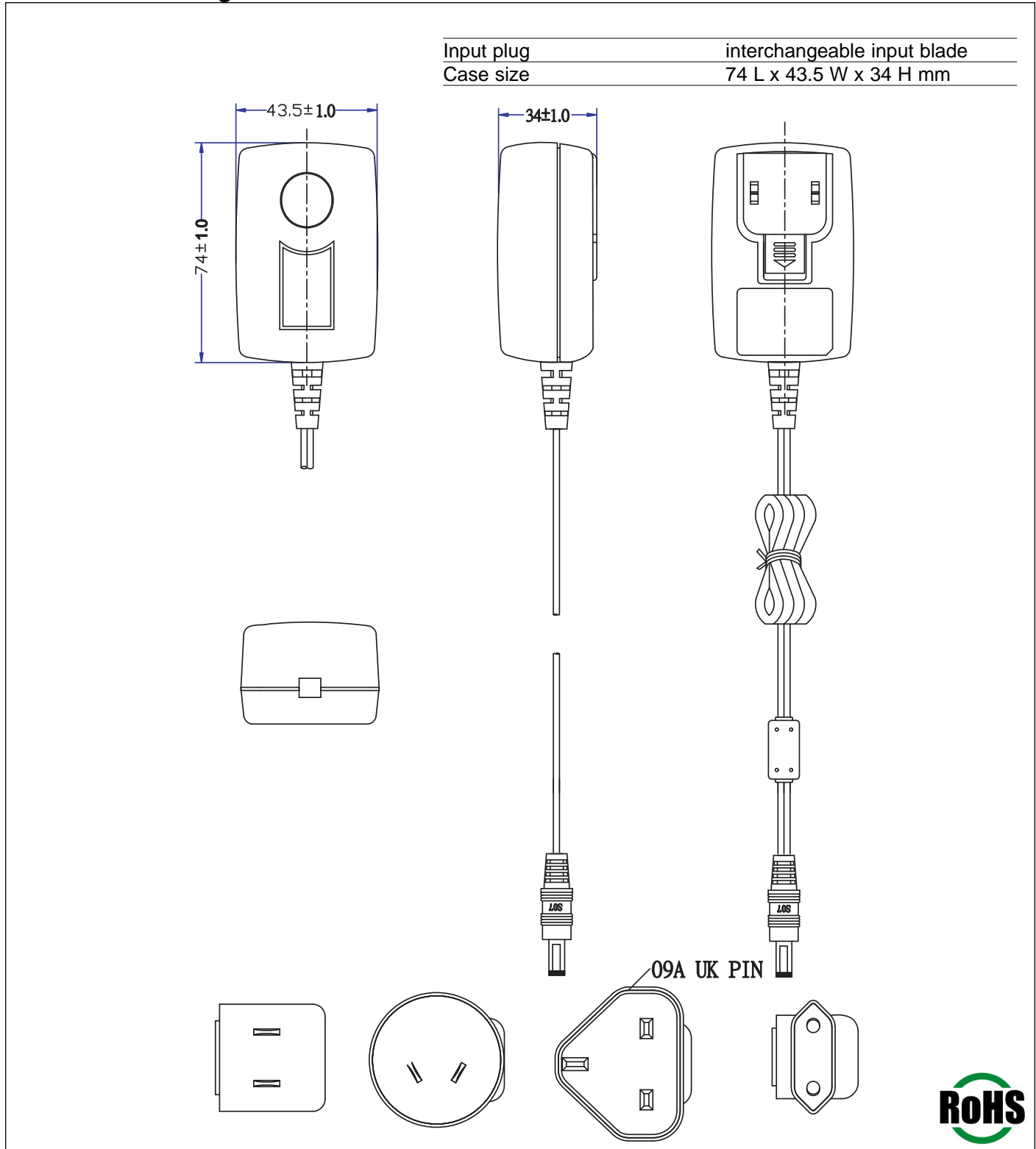
**Mechanical Drawing**



DC Cord

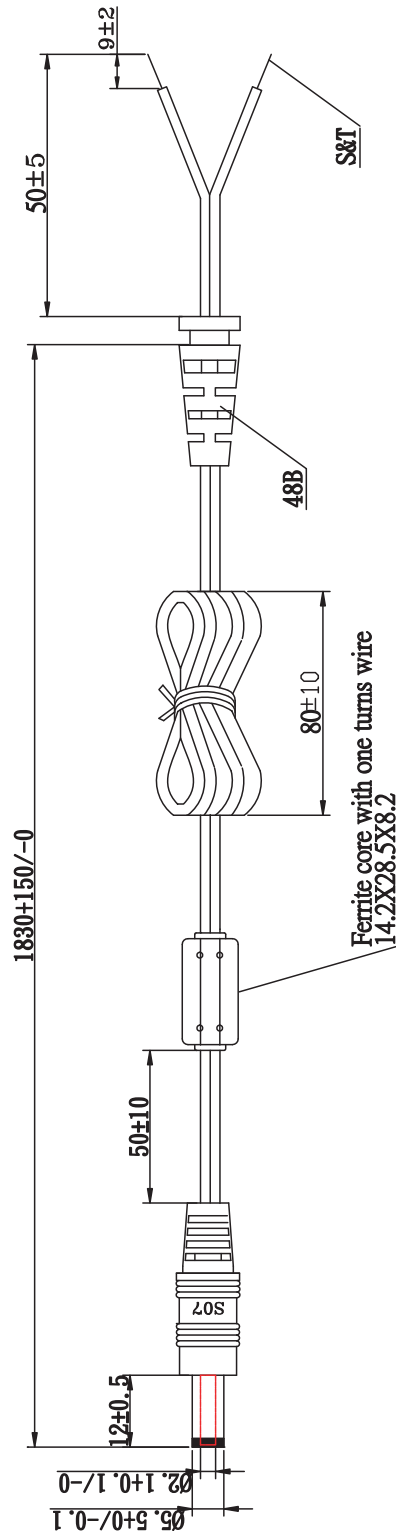

#18AWG X2C SPT-1 HAVE ON WORD WIRE IN OUTER, NO WORD WIRE IN INNER

Wire OD: Ø2.7X5.4 - - - - - +

|                |                        |
|----------------|------------------------|
| VIBRATION TEST | a. ±60°                |
|                | b. WEIGHT 200g         |
|                | c. 40 ROUND/MINUTE     |
|                | d. OVER 1000 COUNT MIN |



**CUI INC**

Part No: EMS060300-P5P-SZ

Description: switching power supply  
w/ interchangeable input blades

Date: 2/15/2008

Unit: mm

Page No: 5 of 6

### Individual Packaging

Tolerance:  $\pm 1$

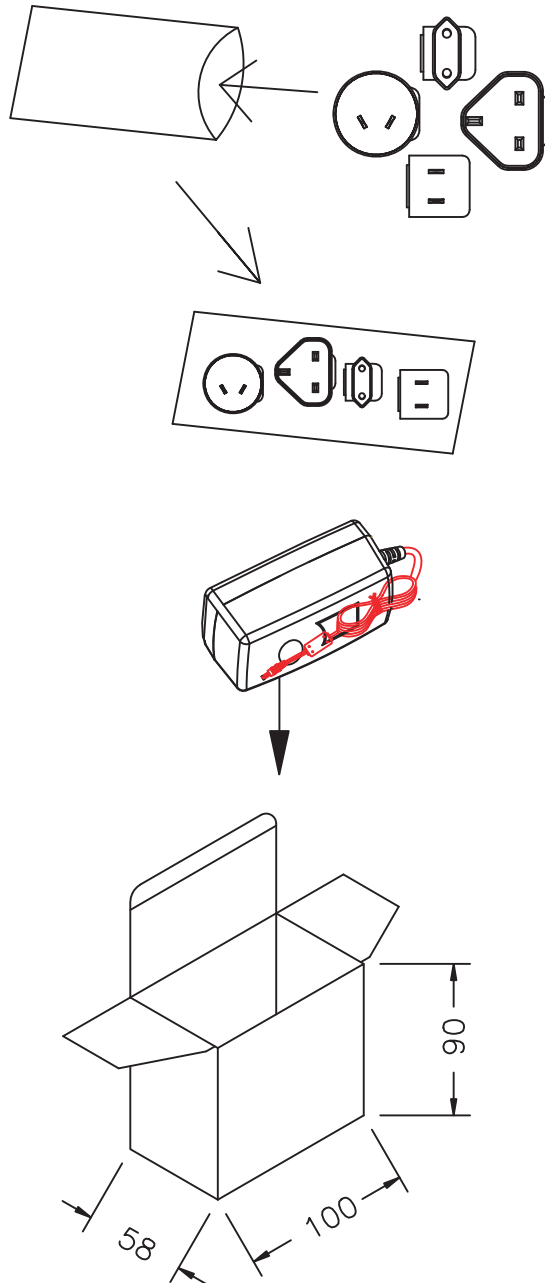

"RoHS Compliant"



**CUI INC**

Part No: EMS060300-P5P-SZ

Description: switching power supply  
w/ interchangeable input blades

Date: 2/15/2008

Unit: mm

Page No: 6 of 6

### Packaging

Tolerance: +7/-0

CARTON SIZE: 485X428X210mm

Q'TY: 60pcs(20x3x1)

**"RoHS Compliant"**

